

Raccoon River Park

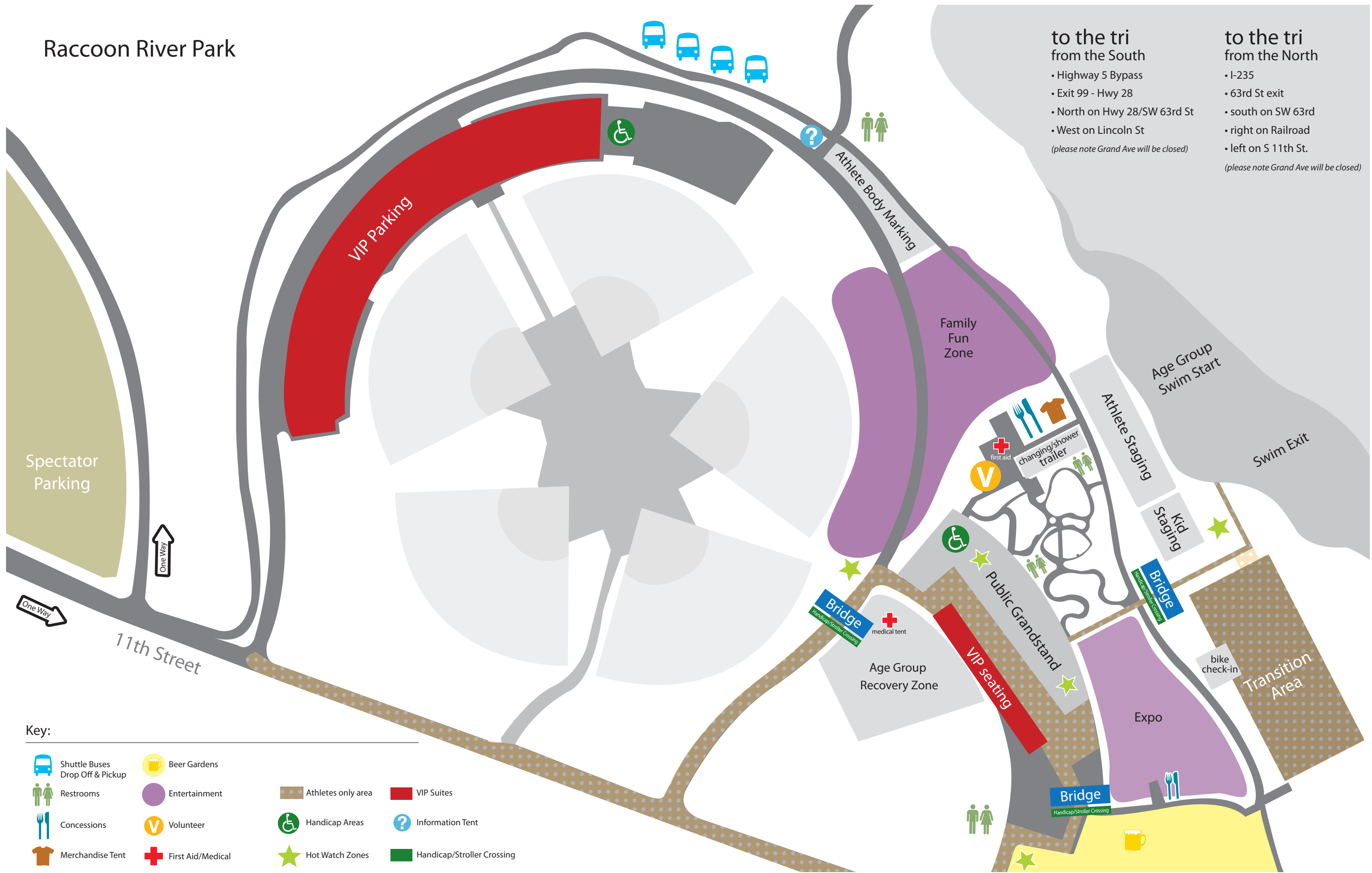

to the tri from the South

- Highway 5 Bypass
- Exit 99 - Hwy 28
- North on Hwy 28/SW 63rd St
- West on Lincoln St

(please note Grand Ave will be closed)

to the tri from the North

- I-235
- 63rd St exit
- south on SW 63rd
- right on Railroad
- left on S 11th St.

(please note Grand Ave will be closed)

Spectator Parking

VIP Parking

Family Fun Zone

Athlete Body Marking

Age Group Swim Start

Swim Exit

changing/shower trailer

Athlete Staging

Kid Staging

Bridge

Public Grandstand

Bridge

Transition Area

Age Group Recovery Zone

VIP seating

Expo

Bridge

Key:

- | | | | | | | | |
|--|---------------------------------|--|-------------------|--|--------------------|--|----------------------------|
| | Shuttle Buses Drop Off & Pickup | | Beer Gardens | | Athletes only area | | VIP Suites |
| | Restrooms | | Entertainment | | Handicap Areas | | Information Tent |
| | Concessions | | Volunteer | | Hot Watch Zones | | Handicap/Stroller Crossing |
| | Merchandise Tent | | First Aid/Medical | | | | |